

NOTICE!!

These documents have been scanned!

Do not place un-scanned documents beneath this notice!

Do not remove this notice from this file!

GPO Jacket No. 560-102
Print Order 61540
Rise Business Services, LLC
Job=AZ15 5/10/2019



Box Number= AZ15032



Claim Begin-End: AMC429417-AMC429419

1 Initial Receipt



AZ15032-20

AMC428906-AMC429539

NO WARRANTY IS MADE BY BLM
FOR USE OF THE DATA FOR
PURPOSES NOT INTENDED BY BLM

United States Department of the Interior
Bureau of Land Management
 LANDS/RECREATION & PLANNING
 ONE N CENTRAL AVE
 PHOENIX, AZ 85004 -2203
 Phone: 602-417-9200

Receipt

ENTERED
 SEP 25 2014
 BY: RAM

No: 3132429

Transaction #: 3224440
Date of Transaction: 09/18/2014
CUSTOMER:
SOUTH BRANCH RESOURCES LLC 580 S PROSPECTORS RD APACHE JUNCTION, AZ 85119-8828 US

LINE #	QTY	DESCRIPTION	REMARKS	UNIT PRICE	TOTAL
1	3.00	LOCATABLE MINERALS / MINING CLAIMS-NEW, UNADJUD, ONE OR MORE AUTH NOS / NEW MINING CLAIMS LOCATION FEE CASES: AMC429417/\$37.00, AMC429418/\$37.00, AMC429419/\$37.00		- n/a -	111.00
2	3.00	LOCATABLE MINERALS / MINING CLAIMS-NEW, UNADJUD, ONE OR MORE AUTH NOS / NEW MINING CLAIM PROCESSING FEE CASES: AMC429417/\$20.00, AMC429418/\$20.00, AMC429419/\$20.00		- n/a -	60.00
3	3.00	LOCATABLE MINERALS / MINING CLAIMS-NEW, UNADJUD, ONE OR MORE AUTH NOS / NEW MINING CLAIMS MAINTENANCE FEE CASES: AMC429417/\$155.00, AMC429418/\$155.00, AMC429419/\$155.00		- n/a -	465.00
TOTAL:					\$636.00

PAYMENT INFORMATION			
1	AMOUNT:	636.00	POSTMARKED: N/A
	TYPE:	CHECK	RECEIVED: 09/18/2014
	CHECK NO:	2225	
	NAME:	SOUTH BRANCH RESOURCES LLC 580 S PROSPECTORS RD APACHE JUNCTION AZ 85119-8828 US	

REMARKS

This receipt was generated by the automated BLM Collections and Billing System and is a paper representation of a portion of the official electronic record contained therein.

NOTICE!!

These documents have been scanned!

Do not place un-scanned documents beneath this notice!

Do not remove this notice from this file!

GPO Jacket No. 560-102
Print Order 61540
Rise Business Services, LLC
Job=AZ15 5/10/2019



Box Number= AZ15032



Claim Begin-End: AMC429417-AMC429419

2 Correspondence



AZ15032-20

AMC428906-AMC429539

**NO
DOCUMENTS
FOUND**

NO DOCUMENTS FOUND
NO DOCUMENTS FOUND

NOTICE!!

These documents have been scanned!

Do not place un-scanned documents beneath this notice!

Do not remove this notice from this file!

GPO Jacket No. 560-102
Print Order 61540
Rise Business Services, LLC
Job=AZ15 5/10/2019



Box Number= AZ15032



Claim Begin-End: AMC429417-AMC429419

3 Transfers



AZ15032-20

AMC428906-AMC429539

**NO
DOCUMENTS
FOUND**

NO DOCUMENTS FOUND
NO DOCUMENTS FOUND

NOTICE!!

These documents have been scanned!

Do not place un-scanned documents beneath this notice!

Do not remove this notice from this file!

GPO Jacket No. 560-102
Print Order 61540
Rise Business Services, LLC
Job=AZ15 5/10/2019



Box Number= AZ15032



Claim Begin-End: AMC429417-AMC429419

4 Annual Filings



AZ15032-20

AMC428906-AMC429539

DEPARTMENT OF THE INTERIOR
BUREAU OF LAND MANAGEMENT
MINING CLAIMS

Run Date/Time: 9/11/2018

MC Maintenance Fees Paid Through the BLM Pay Portal
(by Date Paid)

Page 144 Of 723

CBS Receipt: 4243230

Printed For Lead File # AMC429417

Agency Tracking ID: 1534997134

Assessment Year: 2019

Paid On: 8/23/2018

Number of BLM Serial Nr: 3

Total Amount Paid: \$465.00

Claim Name	BLM Serial No	Lead File No	Amount Paid
BOX-1	AMC429417	AMC429417	\$155.00
BOX-3	AMC429418	AMC429417	\$155.00
BOX-5	AMC429419	AMC429417	\$155.00

United States Department of the Interior
Bureau of Land Management
 BUSINESS & SUPPORT SVCS DIV
 ONE N CENTRAL AVE SUITE 800
 PHOENIX, AZ 85004 -4427
 Phone: 602-417-9200

Receipt

No: 4243230

Transaction #: 4358664	
Date of Transaction: 08/23/2018	
CUSTOMER:	
DANIEL P LAUX 580 S PROPECTORS RD APACHE JUNCTION, AZ 85119 US	

LINE #	QTY	DESCRIPTION	REMARKS	UNIT PRICE	TOTAL
1	1.00	LOCATABLE MINERALS / MINING CLAIMS- NOT NEW-UNADJUD, ONE AUTH NO. ONLY / MINING CLAIM MONEY RECEIVED CASES: AMC429417/\$465.00		- n/a -	465.00
TOTAL:					\$465.00

PAYMENT INFORMATION			
NOTE: Items will appear on credit card statement as "BLM O Mining Claim".			
1	AMOUNT:	465.00	POSTMARKED: N/A
	TYPE:	CREDIT CARD	RECEIVED: 08/23/2018
	NAME:	DANIEL P LAUX 580 S PROPECTORS RD APACHE JUNCTION AZ 85119 US	
	CARD NO:	XXXXXXXXXXXX7035	AUTH CODE: 04446G
	NAME ON CARD:	DANIEL P LAUX	
	SIGNATURE:		

REMARKS

This receipt was generated by the automated BLM Collections and Billing System and is a paper representation of a portion of the official electronic record contained therein.

Amc 429417

Exhibit A - BOX Claim Listing					
South Branch Resources LLC					
580 S Prospectors Rd					
Apache Junction AZ 85119					
August 29, 2017					
Name	AMC#	Maricopa Co. Info	TWP	RNG	SEC
BOX-1	AMC429417	2014-0788006	7N	5W	30
BOX-3	AMC429418	2014-0788007	7N	5W	30
BOX-5	AMC429419	2014-0788008	7N	5W	30



PHOENIX, ARIZONA

2017 AUG 31 A 8:21

RECEIVED
BLM AZ STATE OFFICE

3968899

AT 9/6/17

South Branch Resources LLC
580 S. Prospectors Road
Apache Junction, AZ 85119

August 29, 2017

Arizona State Office
Bureau of Land Management
One N Central Ave, Suite 800
Phoenix AZ 85004-4427

Dear Arizona State Office Personnel,

Enclosed is check totaling \$465.00 for maintenance fees for 3 unpatented mining claims listed on Exhibit A.

Best regards,

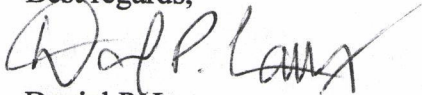

Daniel P. Laux
Member
South Branch Resources LLC



PHOENIX, ARIZONA

2017 AUG 31 A 8:21

RECEIVED
BLM AZ STATE OFFICE

SOUTH BRANCH RESOURCES LLC

580 SOUTH PROSPECTORS ROAD
APACHE JUNCTION, AZ 85119

CERTIFIED MAIL™



7011 0470 0003 1581 3647



1013



85004

U.S. POSTAGE
PAID
APACHE JUN
85120
AUG 29, 17
AMOUNT

\$6.5
R2304M11146

**RETURN RECEIPT
REQUESTED**

RECEIVED
BLM AZ STATE OFFICE

2017 AUG 31 AM 8:21

PHOENIX, ARIZONA

Bureau of Land Management
AZ State office
One N Central Ave, Suite 800
Phoenix AZ 85004-4427

85004-442700



**RETURN RECEIPT
REQUESTED**

**RETURN RECEIPT
REQUESTED**

United States Department of the Interior
Bureau of Land Management
 DIV OF LANDS, MINRLS & ENERGY
 ONE N CENTRAL AVE
 PHOENIX, AZ 85004 -4427
 Phone: 602-417-9200

Receipt

No: 3968899

Transaction #: 4078801	
Date of Transaction: 09/01/2017	
CUSTOMER:	
SOUTH BRANCH RESOURCES LLC 580 S PROSPECTORS RD APACHE JUNCTION, AZ 85119-8828 US	

LINE #	QTY	DESCRIPTION	REMARKS	UNIT PRICE	TOTAL
1	1.00	LOCATABLE MINERALS / MINING CLAIMS- NOT NEW-UNADJUD, ONE AUTH NO. ONLY / MINING CLAIM MONEY RECEIVED CASES: AMC429417/\$465.00	MAINT 2018/3	- n/a -	465.00
TOTAL:					\$465.00

PAYMENT INFORMATION			
1	AMOUNT:	465.00	POSTMARKED: 08/29/2017
	TYPE:	CHECK	RECEIVED: 08/31/2017
	CHECK NO:	2479	
	NAME:	SOUTH BRANCH RESOURCES 580 S PROSPECTORS RD APACHE JUNCTION AZ 85119-8828 US	

REMARKS

This receipt was generated by the automated BLM Collections and Billing System and is a paper representation of a portion of the official electronic record contained therein.

RECEIVED
BLM AZ STATE OFFICE

Amc429417

430195

2016 AUG 24 P 1:45

PHOENIX, ARIZONA
South Branch Resources LLC
580 S. Prospectors Road
Apache Junction, AZ 85119

August 22, 2016

Arizona State Office
Bureau of Land Management
One N Central Ave, Suite 800
Phoenix AZ 85004-4427

Dear Arizona State Office Personnel,

Enclosed are checks totaling \$930.00 for maintenance fees for 6 unpatented mining claims listed on Exhibit A.

Best regards,

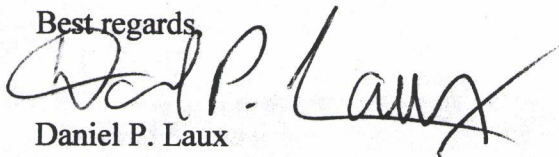

Daniel P. Laux
Member
South Branch Resources LLC

RECEIPT # 3640272

Exhibit A - BOX Claim Listing						
South Branch Resources LLC						
08/22/16						
Name	AMC#	Maricopa Co. Info	TWP	RNG	SEC	
BOX-1	AMC429417	2014-0788006	7N	5W	30	
BOX-2	AMC430195	2015-0090535	7N	5W	30	
BOX-3	AMC429418	2014-0788007	7N	5W	30	
BOX-4	AMC430196	2015-0090536	7N	5W	30	
BOX-5	AMC429419	2014-0788008	7N	5W	30	
BOX-6	AMC430197	2015-0090537	7N	5W	30	

Lead #'s
 429417
 430195

Amc #'s
 429417-419
 430195-197

RECEIVED
 BLM AZ STATE OFFICE
 2016 AUG 24 P 1:45
 PHOENIX, ARIZONA

SOUTH BRANCH RESOURCES LLC

580 SOUTH PROSPECTORS ROAD
APACHE JUNCTION, AZ 85119

Bureau of Land Management
Arizona State Office
One N Central Ave, suite 800
Phoenix AZ 85004-4427

PHOENIX, ARIZONA

2016 AUG 24 P 1:45

RECEIVED
BLM AZ STATE OFFICE

PRIORITY®
★ MAIL ★

FLAT RATE ENVELOPE
ONE RATE ★ ANY WEIGHT*

APPLY PRIORITY MAIL POSTAGE HERE



1021



85004

U.S. POSTAGE
PAID
PHOENIX, AZ
85026
AUG 23, 16
AMOUNT

\$6.45

R2304E105542-19



USPS TRACKING NUMBER

9505 5137 2374 6236 0263 23

Exp. Delivery Day: 08/24/2016

EP14H July 2013

* For international shipments, the maximum weight is 4 lbs.



PS00001000064

EP14H July 2013
OD: 10 x 5

**UNITED STATES
POSTAL SERVICE®**



RECEIVED
BLM AZ STATE OFFICE

54:1 P 42 GNV 9102
2016 AUG 24

PHOENIX, ARIZONA

VISIT US AT **USPS.COM**
ORDER FREE SUPPLIES ONLINE

PRIORITY®
★ MAIL ★

DATE OF DELIVERY SPECIFIED*

USPS TRACKING™ INCLUDED*

INSURANCE INCLUDED*

PICKUP AVAILABLE

* Domestic only

PRESS FIRMLY TO SEAL

PRIORITY®
FLAT RATE ENVELOPE
ONE RATE ★ ANY WEIGHT*

PRIORITY®
★ MAIL ★

TRACKED
INSURED

PRESS FIRMLY TO SEAL

* Domestic only.

This packaging is the property of the U.S. Postal Service® and is provided solely for use in sending Priority Mail® shipments. Misuse may be a violation of Federal law. This packaging is not for resale.

EP14H © U.S. Postal Service; July 2013; All rights reserved.

United States Department of the Interior
Bureau of Land Management
 DIV OF LANDS, MINRLS & ENERGY
 ONE N CENTRAL AVE
 PHOENIX, AZ 85004 -4427
 Phone: 602-417-9200

Receipt

No: 3640272

Transaction #: 3744208	
Date of Transaction: 08/25/2016	
CUSTOMER:	
SOUTH BRANCH RESOURCES LLC 580 S PROSPECTORS RD APACHE JUNCTION, AZ 85119-8828 US	

LINE #	QTY	DESCRIPTION	REMARKS	UNIT PRICE	TOTAL
1	1.00	LOCATABLE MINERALS / MINING CLAIMS- NOT NEW-UNADJUD, ONE AUTH NO. ONLY / MINING CLAIM MONEY RECEIVED CASES: AMC429417/\$930.00	MAINT FEE 2017 - 6	- n/a -	930.00
TOTAL:					\$930.00

PAYMENT INFORMATION					
1	AMOUNT:	465.00	POSTMARKED:	08/23/2016	
	TYPE:	CHECK	RECEIVED:	08/24/2016	
	CHECK NO:	2381			
	NAME:	SOUTH BRANCH RESOURCES LLC 580 S PROSPECTORS RD APACHE JUNCTION AZ 85119-8828 US			
2	AMOUNT:	465.00	POSTMARKED:	08/23/2016	
	TYPE:	CHECK	RECEIVED:	08/24/2016	
	CHECK NO:	5518			
	NAME:	NEWCOMER, ROBERT W 7823 QUINTANA DR NE ALBUQUERQUE NM 87109 US			

REMARKS

This receipt was generated by the automated BLM Collections and Billing System and is a paper representation of a portion of the official electronic record contained therein.

ENTERED
AUG 26 2016
 BY: *[Signature]*

429417
430195

South Branch Resources LLC
580 S. Prospectors Road
Apache Junction, AZ 85119

August 25, 2015

Arizona State Office
Bureau of Land Management
One N Central Ave, Suite 800
Phoenix AZ 85004-4427

Dear Arizona State Office Personnel,

Enclosed are checks totaling \$930.00 for maintenance fees for 6 unpatented mining claims listed on Exhibit A.

Best regards,

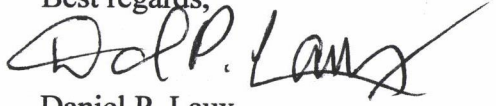

Daniel P. Laux
Member
South Branch Resources LLC

RECEIVED
BLM AZ DIST OFFICE
2015 AUG 26 P 3:18
PHOENIX, ARIZONA

RECEIPT # 338257

ENTERED
AUG 28 2015
BY: R. Brown

Exhibit A - Coyote Springs Claim Listing							
South Branch Resources LLC							
	Name	AMC#	Maricopa Co. Info	TWP	RNG	SEC	
	BOX-1	AMC429417	2014-0788006	7N	5W	30	
	BOX-2	AMC430195	2015-0090535	7N	5W	30	
	BOX-3	AMC429418	2014-0788007	7N	5W	30	
	BOX-4	AMC430196	2015-0090536	7N	5W	30	
	BOX-5	AMC429419	2014-0788008	7N	5W	30	
	BOX-6	AMC430197	2015-0090537	7N	5W	30	

RECEIVED
 BLM AZ STATE OFFICE
 2015 AUG 26 P 3:19
 PHOENIX, ARIZONA

PRIORITY®
★ MAIL ★

FLAT RATE ENVELOPE
ONE RATE ★ ANY WEIGHT*

APPLY PRIORITY MAIL POSTAGE HERE



1021



85004

U.S. POSTAGE
PAID
APACHE JUNCTION, AZ
85120
AUG 25, 15
AMOUNT

\$5.75
R2304M111467-04

Expected Delivery Day: 08/26/2015

USPS TRACKING NUMBER



9505 5125 0265 5237 0783 73

EPI4H July 2013 Outer Dimension: 10 x 5

** For International shipment

VISIT US AT **USPS.COM**
ORDER FREE

* Domestic only

PICKUP AVAILABLE

INSURANCE INCLUDED

USPS TRACKING™ INCLUDED

DATE OF DELIVERY SPECIFIED

PRIORITY®
★ MAIL ★



EPI4H July 2013
OD: 10 x 5

UNITED STATES
POSTAL SERVICE®



PRESS FIRMLY TO SEAL



PRIORITY®
FLAT RATE ENVELOPE
ONE RATE ★ ANY WEIGHT*

PRIORITY®
★ MAIL ★

PRESS FIRMLY TO SEAL

* Domestic only.

This packaging is the property of the U.S. Postal Service® and is provided solely for use in sending Priority Mail® shipments. Misuse may be a violation of federal law. This packaging is not for resale.

EPI4H © U.S. Post
ice; July 2013; All rights reserved.

SOUTH BRANCH RESOURCES LLC

580 SOUTH PROSPECTORS ROAD
APACHE JUNCTION, AZ 85119

Bureau of Land Management
Arizona State Office
One N Central Ave, Suite 800
Phoenix AZ 85004

United States Department of the Interior
Bureau of Land Management
 LANDS/RECREATION & PLANNING
 ONE N CENTRAL AVE
 PHOENIX, AZ 85004 -2203
 Phone: 602-417-9200

Receipt

No: 3378257

Transaction #: 3476510	
Date of Transaction: 08/27/2015	
CUSTOMER:	
SOUTH BRANCH RESOURCES LLC 580 S PROSPECTORS RD APACHE JUNCTION, AZ 85119-8828 US	

LINE #	QTY	DESCRIPTION	REMARKS	UNIT PRICE	TOTAL
1	1.00	LOCATABLE MINERALS / MINING CLAIMS- NOT NEW-UNADJUD, ONE AUTH NO. ONLY / MINING CLAIM MONEY RECEIVED CASES: AMC429417/\$930.00	MAINT FEE PYMNT - 6 2016	- n/a -	930.00
TOTAL:					\$930.00

PAYMENT INFORMATION					
1	AMOUNT:	465.00	POSTMARKED:	08/25/2015	
	TYPE:	CHECK	RECEIVED:	08/26/2015	
	CHECK NO:	2315			
	NAME:	SOUTH BRANCH RESOURCES LLC 580 S PROSPECTORS RD APACHE JUNCTION AZ 85119-8828 US			
2	AMOUNT:	465.00	POSTMARKED:	08/25/2015	
	TYPE:	CHECK	RECEIVED:	08/26/2015	
	CHECK NO:	5411			
	NAME:	NEWCOMER, ROBERT W 7823 QUINTANA DR NE ALBUQUERQUE NM 87109 US			

REMARKS

This receipt was generated by the automated BLM Collections and Billing System and is a paper representation of a portion of the official electronic record contained therein.

ENTERED
 AUG 28 2015
 BY: *R. [Signature]*

NOTICE!!

These documents have been scanned!

Do not place un-scanned documents beneath this notice!

Do not remove this notice from this file!

GPO Jacket No. 560-102
Print Order 61540
Rise Business Services, LLC
Job=AZ15 5/10/2019



Box Number= AZ15032



Claim Begin-End: AMC429417-AMC429419

5 Miscellaneous



AZ15032-20

AMC428906-AMC429539

The United States of America,

To all to whom these presents shall come, Greeting:

WHEREAS, under the provisions of Section 8 of the Act of June 28, 1934 (48 Stat. 1269), entitled "An Act To stop injury to the public grazing lands by preventing overgrazing and soil deterioration, to provide for their orderly use, improvement, and development, to stabilize the livestock industry dependent upon the public range, and for other purposes," as amended by Section 3 of the Act of June 26, 1936 (49 Stat. 1976), the State of Arizona, in exchange for certain other lands situated in said State, has selected the following described tracts of land:

Gila and Salt River Meridian, Arizona.

Township seven north of Range ten west.

The north half, the southwest quarter, the north half of the southeast quarter, and the southwest quarter of the southeast quarter of Section thirty-three;

Township seven north of Range five west.

The Sections nineteen, twenty-one, twenty-eight, and thirty, containing, in the aggregate, three thousand one hundred sixty-one acres and thirty-four hundredths of an acre, according to the Official Plats of the Surveys of the said Lands, on file in the General Land Office:

NOW KNOW YE, That the UNITED STATES OF AMERICA, in consideration of the premises, and in conformity with the said Acts of Congress, HAS GIVEN AND GRANTED, and by these presents DOES GIVE AND GRANT, unto the said State of Arizona, in fee simple, the tracts of land above described; TO HAVE AND TO HOLD the same, together with all the rights, privileges, immunities, and appurtenances, of whatsoever nature thereunto belonging, unto the said State of Arizona, and to its assigns forever; subject to any vested and accrued water rights for mining, agricultural, manufacturing, or other purposes, and rights to ditches and reservoirs used in connection with such water rights, as may be recognized and acknowledged by the local customs, laws, and decisions of courts; and there is reserved from the lands hereby granted, a right of way thereon for ditches or canals constructed by the authority of the United States. Reserving, also, to the United States all minerals in the lands so granted, together with the right to prospect for, mine, and remove the same, as authorized by the provisions of said section 8 as amended as aforesaid.

IN TESTIMONY WHEREOF, I, **Franklin D. Roosevelt,**

President of the United States of America, have caused these letters to be made

Patent, and the Seal of the General Land Office to be hereunto affixed.

GIVEN under my hand, at the City of Washington, the **THIRTEENTH**

[SEAL]

day of **AUGUST** in the year of our Lord one thousand

nine hundred and **FORTY-ONE** and of the Independence of the

United States the one hundred and **SIXTY-SIXTH**

By the President:

Franklin D. Roosevelt

By

Jeanne Swanaght Secretary.

R. S. Clinton

1111858

Chief, Patents Division, ~~XXXXX~~ General Land Office.

NOTICE!!

These documents have been scanned!

Do not place un-scanned documents beneath this notice!

Do not remove this notice from this file!

GPO Jacket No. 560-102
Print Order 61540
Rise Business Services, LLC
Job=AZ15 5/10/2019



Box Number= AZ15032



Claim Begin-End: AMC429417-AMC429419

6 Location Notices-Amendments and Supporting Documents



AZ15032-20

AMC428906-AMC429539

Mining Claim Status Report

Data Entered: 9/25/14 Rdm

MTP Checked By: AME
GEO Checked By: AME

LEAD SERIAL NUMBER: AMC 429417 thru AMC 429419

NUMBER OF CLAIMS & TYPE:

- 3 LODE
- PLACER
- ASSOCIATION PLACER
- MILL SITE
- TUNNEL SITE

CHARGES:

Location Fee @ \$37 =	\$	<u>110.00</u>
Processing Fee @ \$20 =	\$	<u>60</u>
Maintenance Fee @ \$155 =	\$	<u>465</u>
Add'l Maint Fee for Assoc Placer =	\$	
SUBTOTAL	\$	
Other Fees	\$	
Other Fees	\$	
TOTAL	\$	<u>636</u>

TOTAL ACREAGE: _____ Per Claim
(Placer Only)

NUMBER OF LOCATORS: _____

DOCUMENTS RECEIVED VIA : Over-the-Counter [] Mail [] TIMELY FILED: Yes [] No []

LEGAL DESCRIPTION: T 7N R SW SEC 30

T _____ R _____ SEC _____

T _____ R _____ SEC _____

T _____ R _____ SEC _____

T _____ R _____ SEC _____

BLM [] FOREST SERVICE [] SUBJ TO PL 359: Yes [] No []
WILDERNESS AREA []

SPLIT ESTATE: N/A [] SX [] PX [] OTHER []
SRHA [] Was proper Notice filed if located on SHRA Land? Yes [] No []

RECONVEYED MINERALS ON BLM LAND REQUIRE OPENING ORDER FROM 1944 TO 1993:

Open to Entry On _____ N/A []

COMMENTS/STATUS: VOID [] PARTIALLY VOID [] PVT MINERALS [] WITHDRAWN LANDS []
OTHER []

1111858

Could use a better map that clearly show entire boundaries of section 30 & clearly shows SE of section 30 since that is used as beginning pt for M&B
[] Claimant acknowledges that portions of the following claim(s) site(s) may be void or voidable.

But used the reference to the SE corner of section 30 to depict the claims on the MTP & adjudicate from there - Claimants could still

Printed Name of Claimant _____

Signature of Claimant _____

*****FINAL ADJUDICATION*****

DATE 4-6-15 INITIALS RE

file map to verify more clearly where claims lie & corroborate our interpretation

AMC 429417

LOCATION NOTICE FOR LODE MINING CLAIM

NOTICE IS HEREBY GIVEN that the **BOX-1** lode mining claim has been located by **South Branch Resources LLC, 580 S Prospectors Rd, Apache Junction, AZ 85119.**

The general course of this claim is **East-West** and it is situated in **Maricopa** County, Arizona. The claim is **1500** feet in length and **600** feet in width. This claim runs from the location monument on which this location notice is posted approximately **20** feet in a **East** direction to the **East** end line and **1480** feet in a **West** direction to the **West** end line. This claim is marked by six monuments, one at each corner and one at the center of each end line of the claim.

The location monument on which this notice is posted is situated within **Section 30, Township 7 N, Range 5 W**, Gila Salt River Base and Meridian, Arizona and this claim encompasses portions of the following quarter section(s): **SW1/4 and SE1/4, section 30, T7N, R5W**, Gila Salt River Base Meridian, Arizona. The locality of this claim with reference to some natural object or permanent monument and additional information (if any) concerning its locality are as follows: Northeast corner of claim is **2245** feet **N72W** from Southeast corner of **section 30, T7N, R5W, GSRB&M.**

DATED AND POSTED on the ground this 5 day of **September, 2014**

Agent:

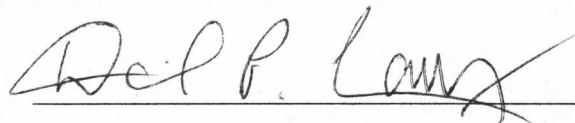

Daniel P. Laux

PHOENIX, ARIZONA

2014 SEP 18 P 3:43

RECEIVED
M AZ STATE OFFICE

AMC429417

MINING CLAIM MAP

Lode Placer ()

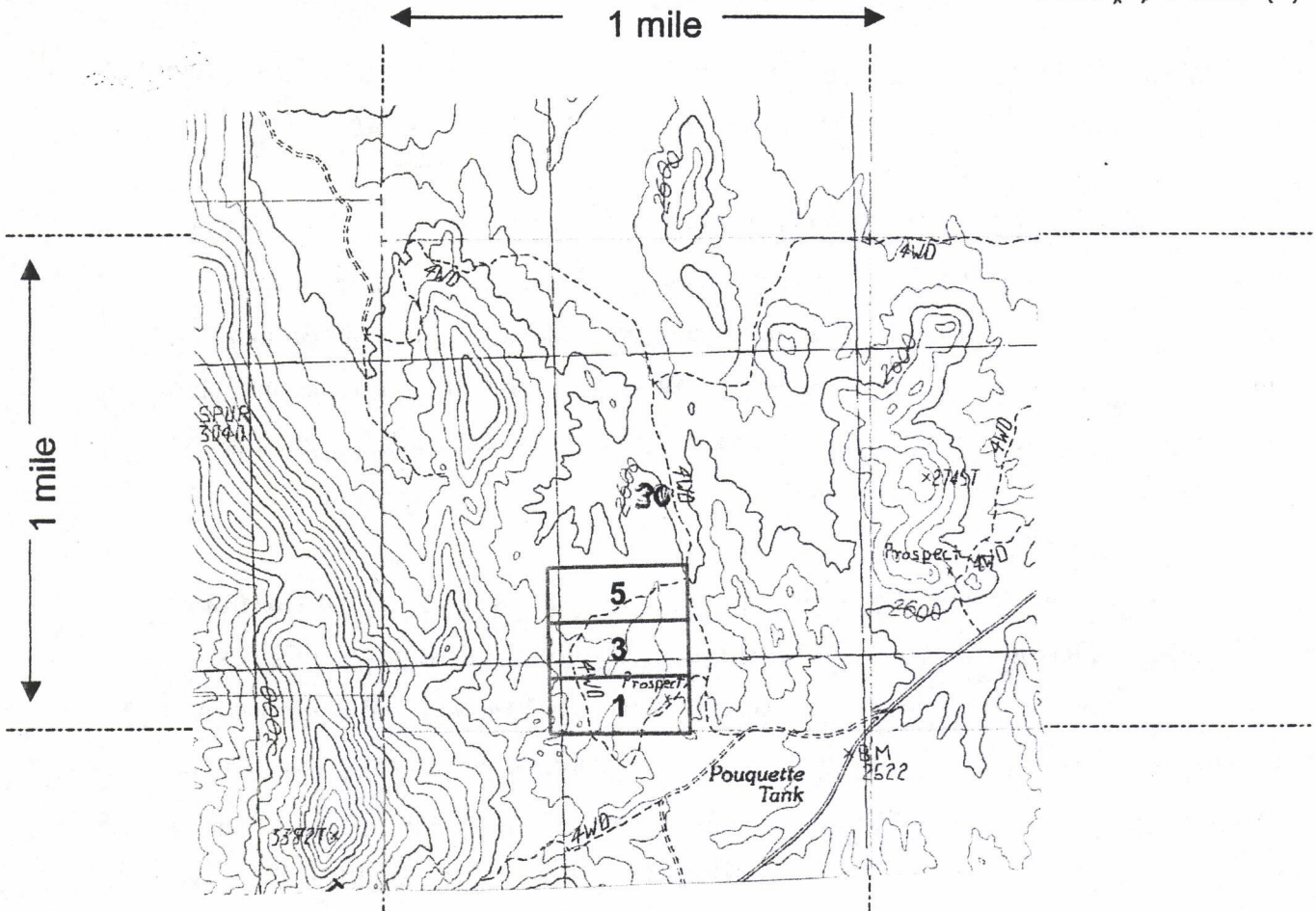

Scale : 1" = 2000 feet



1. The above map depicts the BOX - 1 mining claim, which is located in Section (s) 30, Township 7 N, Range 5 W, Gila and Salt River Base and Meridian, Maricopa County, Arizona.

2. The type of corner and location monuments used are as follows: wood 2x2

3. The bearings and distances in degrees and feet between claim corners are as depicted on the map.

Form MCF100a
Revised July 2005

This form is available from the Arizona Department of Mines & Mineral Resources and may be reproduced.

AMC429417

LOCATION NOTICE FOR LODE MINING CLAIM

NOTICE IS HEREBY GIVEN that the **BOX-3** lode mining claim has been located by **South Branch Resources LLC, 580 S Prospectors Rd, Apache Junction, AZ 85119.**

The general course of this claim is **East-West** and it is situated in **Maricopa** County, Arizona. The claim is **1500** feet in length and **600** feet in width. This claim runs from the location monument on which this location notice is posted approximately **20** feet in a **East** direction to the **EAST** end line and **1480** feet in a **West** direction to the **West** end line. This claim is marked by six monuments, one at each corner and one at the center of each end line of the claim.

The location monument on which this notice is posted is situated within **Section 30, Township 7 N, Range 5 W**, Gila Salt River Base and Meridian, Arizona and this claim encompasses portions of the following quarter section(s): **SW1/4 and SE1/4, section 30, T7N, R5W**, Gila Salt River Base Meridian, Arizona. The locality of this claim with reference to some natural object or permanent monument and additional information (if any) concerning its locality are as follows: Northeast corner of claim is **2668** feet **N58W** from Southeast corner of **section 30, T7N, R5W, GSRB&M.** ¹⁰⁵

DATED AND POSTED on the ground this 5 day of **September, 2014**

Agent:

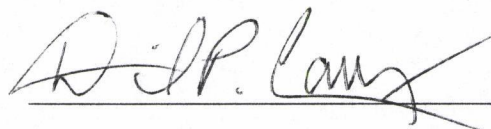

Daniel P. Laux

PHOENIX, ARIZONA

2014 SEP 18 P 3:43

RECEIVED
LM AZ STATE OFFICE

AMC 4294181

MINING CLAIM MAP

Lode (X) Placer ()

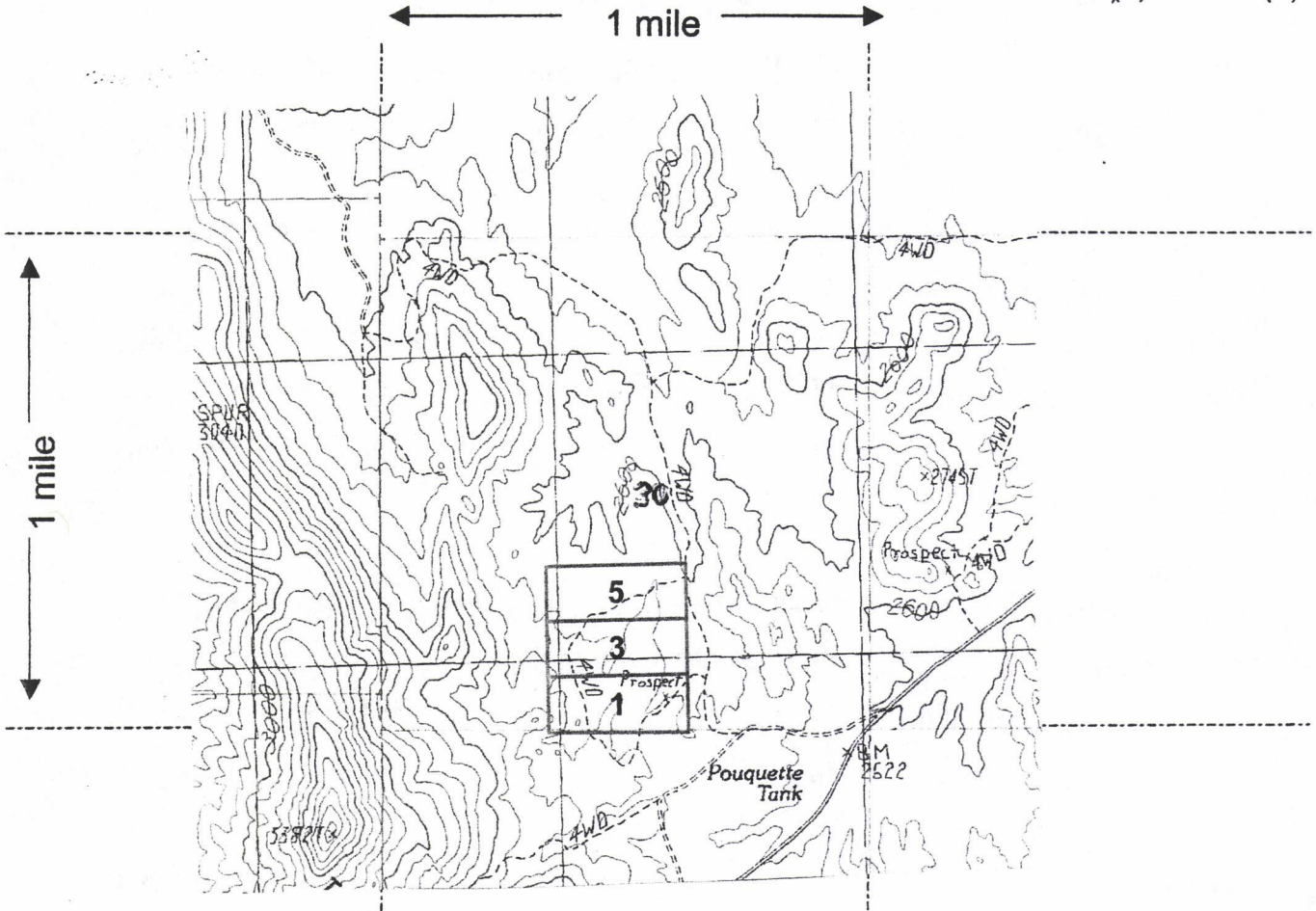

Scale : 1" = 2000 feet



1. The above map depicts the BOX-3 mining claim, which is located in Section (s) 30, Township 7 N, Range 5 W, Gila and Salt River Base and Meridian, Maricopa County, Arizona.

2. The type of corner and location monuments used are as follows: wood 2x2

3. The bearings and distances in degrees and feet between claim corners are as depicted on the map.

Form MCF100a
Revised July 2005

This form is available from the Arizona Department of Mines & Mineral Resources and may be reproduced.

AMC429418

LOCATION NOTICE FOR LODE MINING CLAIM

NOTICE IS HEREBY GIVEN that the **BOX-5** lode mining claim has been located by **South Branch Resources LLC, 580 S Prospectors Rd, Apache Junction, AZ 85119.**

The general course of this claim is **East-West** and it is situated in **Maricopa** County, Arizona. The claim is **1500** feet in length and **600** feet in width. This claim runs from the location monument on which this location notice is posted approximately **20** feet in a **East** direction to the **EAST** end line and **1480** feet in a **West** direction to the **West** end line. This claim is marked by six monuments, one at each corner and one at the center of each end line of the claim.

The location monument on which this notice is posted is situated within **Section 30, Township 7 N, Range 5 W**, Gila Salt River Base and Meridian, Arizona and this claim encompasses portions of the following quarter section(s): **SW1/4 and SE1/4, section 30, T7N, R5W**, Gila Salt River Base Meridian, Arizona. The locality of this claim with reference to some natural object or permanent monument and additional information (if any) concerning its locality are as follows: Northeast corner of claim is **2996** feet **N47W** from Southeast corner of **section 30, T7N, R5W, GSRB&M.**

$$\begin{array}{r} 165 \\ 165 \\ \hline 1346 \end{array}$$

DATED AND POSTED on the ground this 5 day of **September, 2014**

Agent:

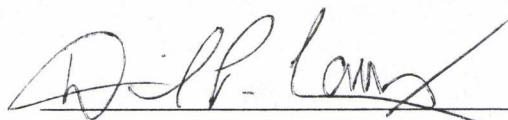

Daniel P. Laux

PHOENIX, ARIZONA

2014 SEP 18 P 3:43

RECEIVED
M AZ STATE OFFICE

AMC 429419

MINING CLAIM MAP

Lode Placer ()

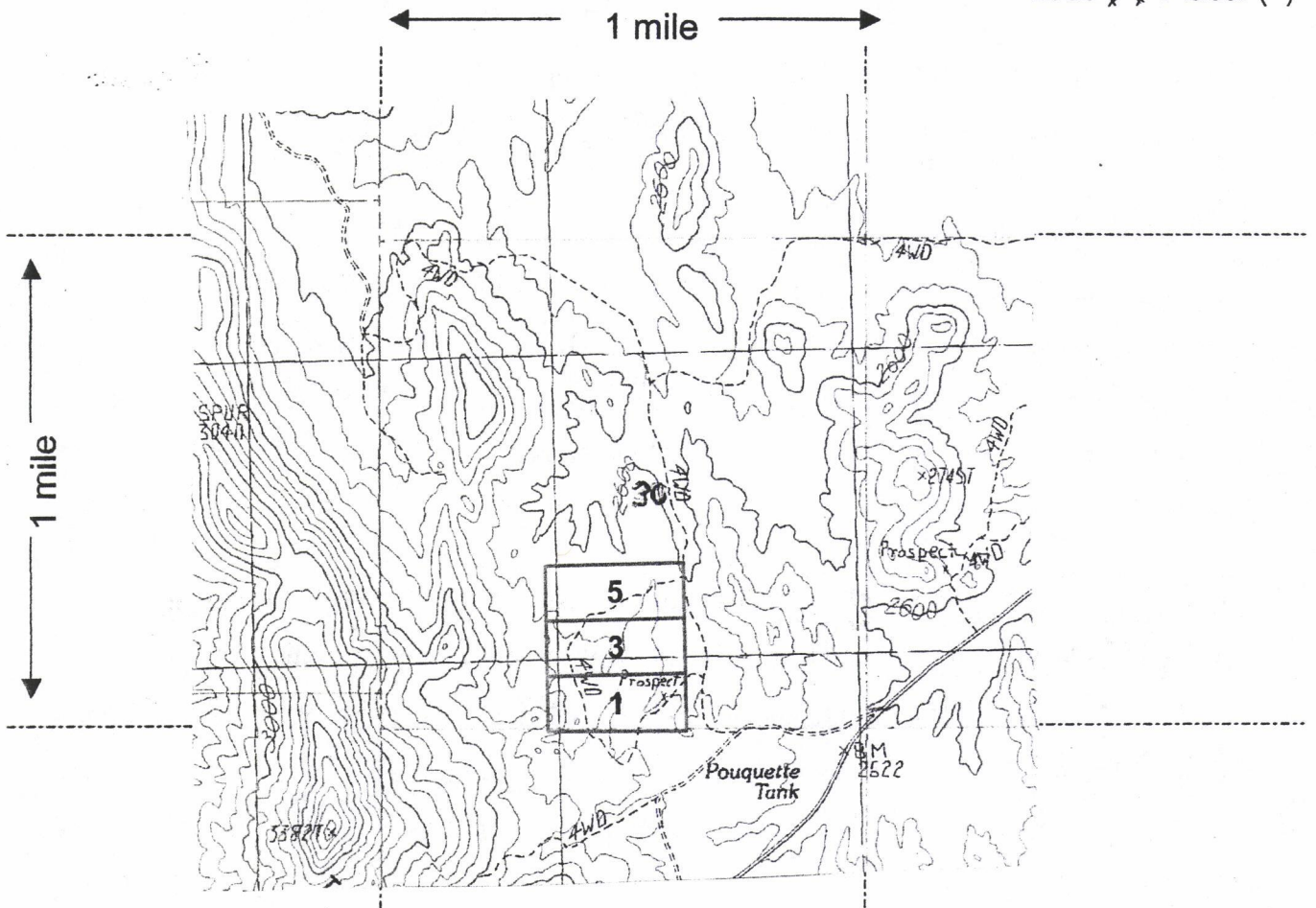

Scale : 1" = 2000 feet



1. The above map depicts the BOX-5 mining claim, which is located in Section (s) 30, Township 7 N, Range 5 W, Gila and Salt River Base and Meridian, Maricopa County, Arizona.

2. The type of corner and location monuments used are as follows: wood 2x2

3. The bearings and distances in degrees and feet between claim corners are as depicted on the map.

Form MCF100a
Revised July 2005

AMC4294191

Input Parameters for Geographic Report with Land

System Id = CR

Admin State = AZ

Geo State =

Casetype Begins With

Case Disp Txt = AUTHORIZED, CANCELLED, EXPIRED, PENDING, REJECTED, RELINQUISHED, WITHDRAWN

Mer Twp Rng =

Section =

Mtrs = 14 0070N 0050W 030, 14 0070N 0050W 999

Commodity =

Commodity Txt =

Pending Org =

Pend Org Decode =

Total Rows Returned: 2

RUN TIME: 10:25 AM

UNITED STATES DEPARTMENT OF INTERIOR
BUREAU OF LAND MANAGEMENT
GEOGRAPHIC REPORT WITH LAND
Sorted by Serial Number

RUN DATE: 09/25/2014
Page 1 of 1

Adm State: AZ

Serial Number: AZA 035199
Total Case Acres: 5.000

<u>Casetype</u>	<u>Case Disp</u>				<u>Sect</u>	<u>Sur Typ</u>	<u>Sur Num</u>	<u>Suff</u>	<u>Subdivision</u>	<u>Act Pend</u>
380913	EXPIRED	14	0070N	0050W	030	ALIQ LOTS			E2,E2W2; 1-4;	

